



PL00182 Series Bi-Color SMD LED 1210 Package

Features

- *Flat Lens Package 3.2 x 2.7 x 1.1 mm
- *AlGaAs Super Bright Red and GaP Green Chip used
- *High Light Output
- *Compatible with IR Solder-Process
- *Industry Standard Footprint
- *3000 pcs. per Reel
- *RoHS Compliant

Absolute Maximum Ratings at T_A = 25 °C

Power Dissipation (Red).....	69mW
Power Dissipation (Green).....	78mW
Reverse Voltage (<100µA).....	5.0V
Max Forward Current.....	30mA
Peak Forward Current (1/10 Duty Cycle, 0.1ms Pulse Width).....	100mA
Operating Temperature Range.....	-30°C to + 80°C
Storage Temperature Range.....	-40°C to + 85°C
Reflow Soldering Temperature.....	260°C for 10 seconds

Electrical & Optical Characteristics at T_A = 25 °C

Part Number	Emitting Color	Chip Material	Dominant Wave Length	Peak Wave Length	Viewing Angle 2θ ½	Forward Voltage @20mA (V)		Luminous Intensity @20mA (mcd)	
						Typ	Max	Min	Typ
Water Clear Lens			nm	nm	Deg				
PL00182-WCRG2013	Deep Red Green	AlGaAs GaP	643 570	660 568	130°	1.9 2.2	2.3 2.6	9.0 8.0	16.0 15.0

Package Dimensions are in **Millimeters**. Tolerance is ± 0.1mm unless otherwise specified.

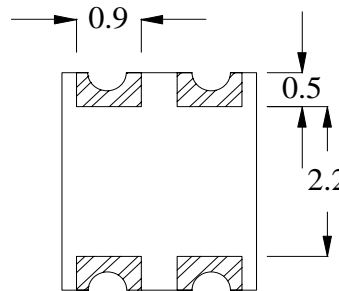
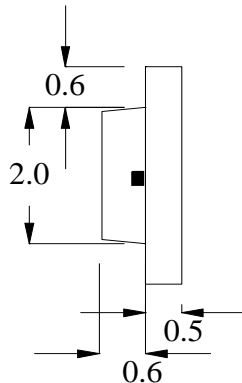
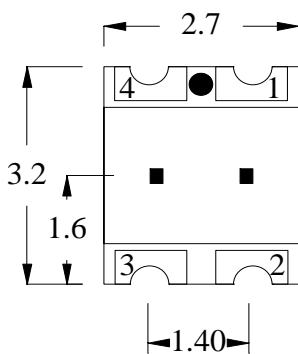

Polarity

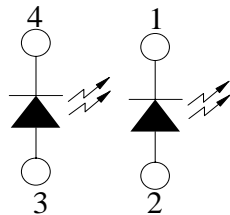

Recommended Solder Pad Layout

